



HYDRAULIC VALVES AND ACCESSORIES

ELECTRIC CONTROL HANDLES

OVERVIEW

The CBI electric operator control handle may be needed when adding an additional hydraulic function to your lift truck. The handle mounts on the existing lever with minimal modification required.

FEATURES

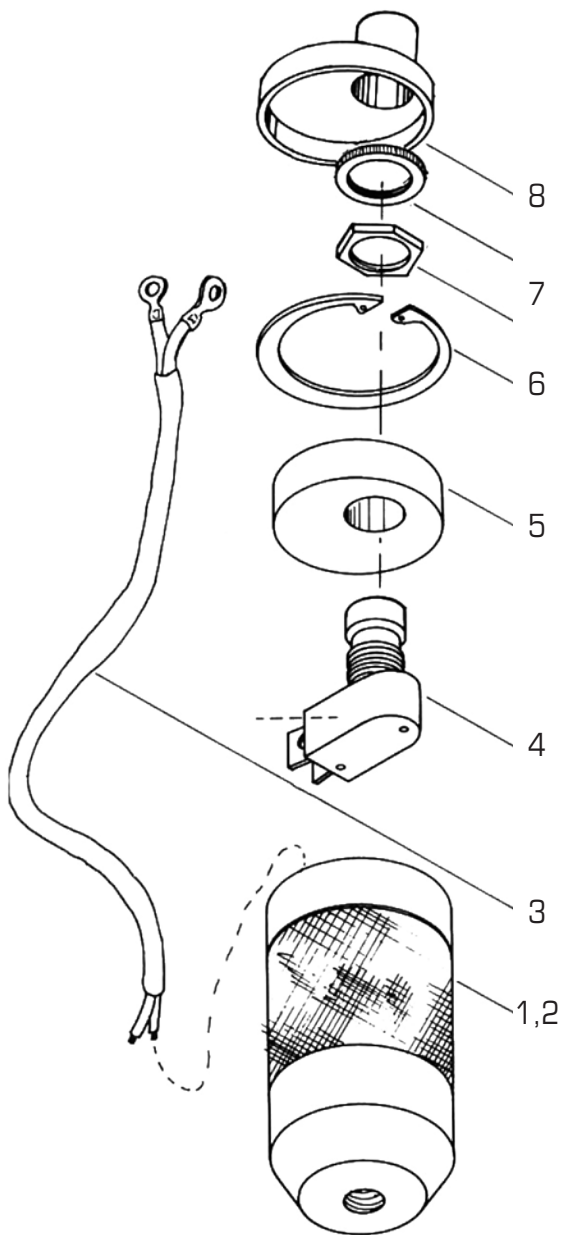
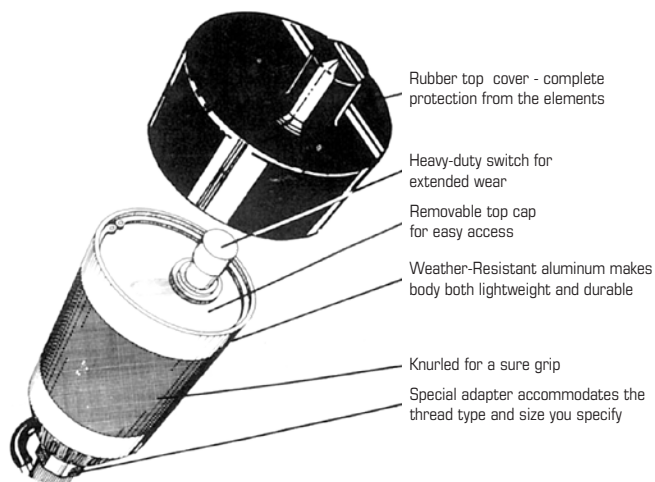

PART NUMBERS

Electric Operator Control Handle		
Item#	Part Number	Description
	CB-9000	One Button Assembly
	CB-9000-1	Two Button Assembly
Replacement Parts		
1	CB-9000-A	Handle (Body Only, 1 button)
2	CB-9000-A-2	Handle (Body Only, 2 button)
3	CB-9000-B	Wire with terminals
4	CB-9000-C	Button Switch Only
5	CB-9000-D	Cap
6	CB-9000-E	Snap Ring (2 per assy)
7	CB-9000-F	Nut and Ring
8	CB-9000-g	Rubber Cap

RELATED PRODUCTS

- Waterman valves page G-3
- 2 and 3 function kits page G-1
- Relief valves and pressure gauges G-4
- Sideshift check valve page G-4
- Revolving Connector page G-6
- Hydraulic Fittings page G-7
- Hydraulic Drive Motors page G-5

